

2D Plan

Because it's such a large-scale project, we're planning to deliver it in stages. We have funding available to deliver the first and largest stage of the project, which comes under the title of the **Eildon Reserves Redevelopment**. Stage one of the project will see the redevelopment of Walter Moore Reserve, with construction of a new regional play space, splash park, toilets and change rooms, picnic shelter, as well as installation of new footpaths and upgrades to park furniture

KEY

Elements included in stage one. Construction of stage one commences February 2023, with the aim of completing by June 2024.

Elements included in future stages

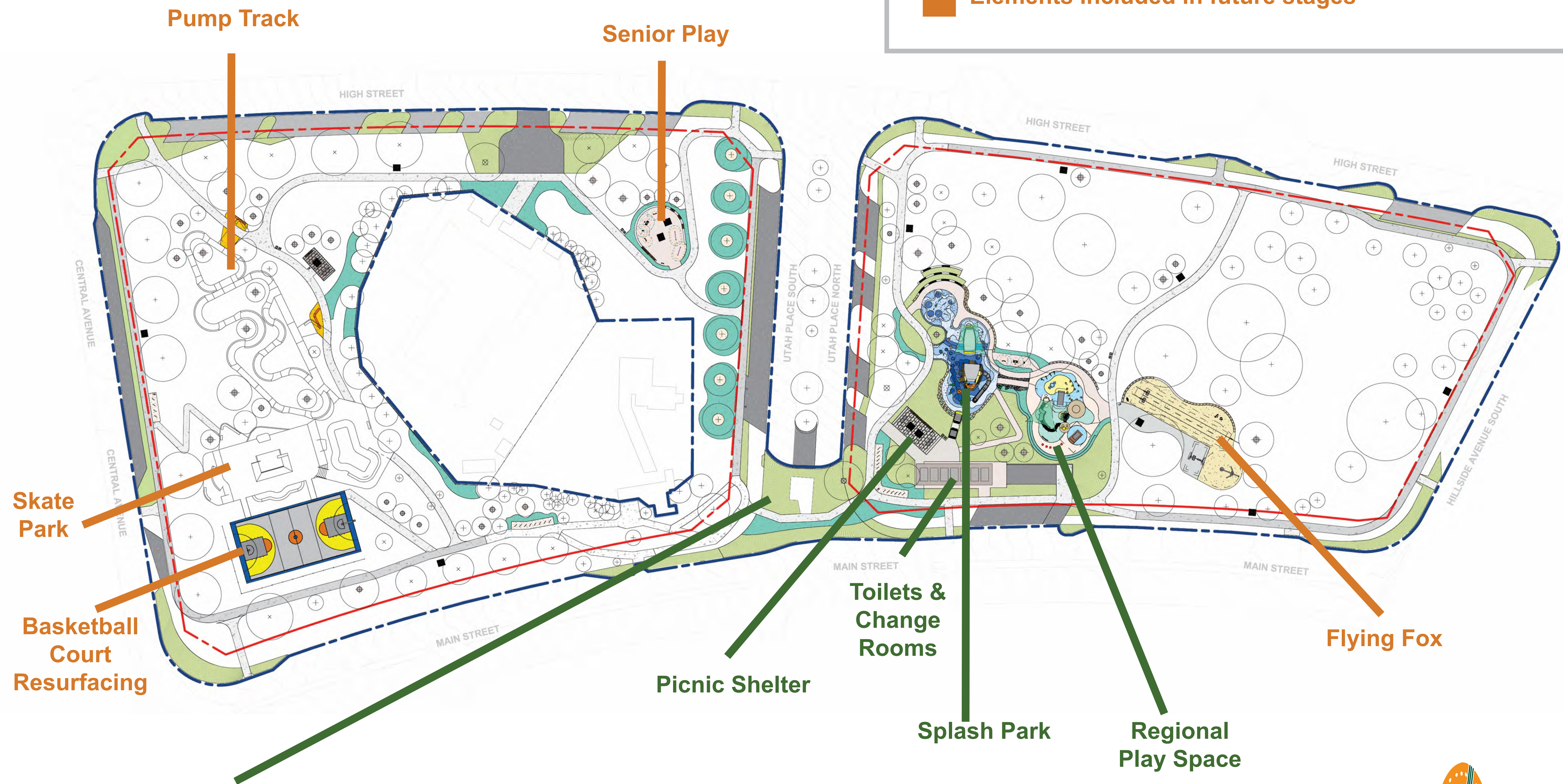

The pedestrian link across Utah Place will change traffic conditions and make it a no-through road